

LOS ANGELES UNIFIED SCHOOL DISTRICT CANYON CHARTER SCHOOL CLASSROOM BUILDING

Los Angeles Unified School District | Los Angeles, CA

JOHNSONFAVARO

THE CLASSROOM REPLACEMENT PROJECT INCLUDES:

- Demolition of 2 kinder classrooms and portable buildings with 7 regular classrooms
- A new 2-story building with 9 classrooms & instructional support spaces
- Re-routing of underground sewer line for service to new structures
- Installation of interim housing to support school operations during construction
- New wiring for classroom interconnection network and information technology
- Relocation, within the campus, of the historical schoolhouse building
- New landscape, hardscape, and playground with heat-reducing solar-reflective pavement coating
- Improvements per Americans with Disabilities Act (ADA)

Phase 1 – Replacement of DOH Relocatable Classroom Building

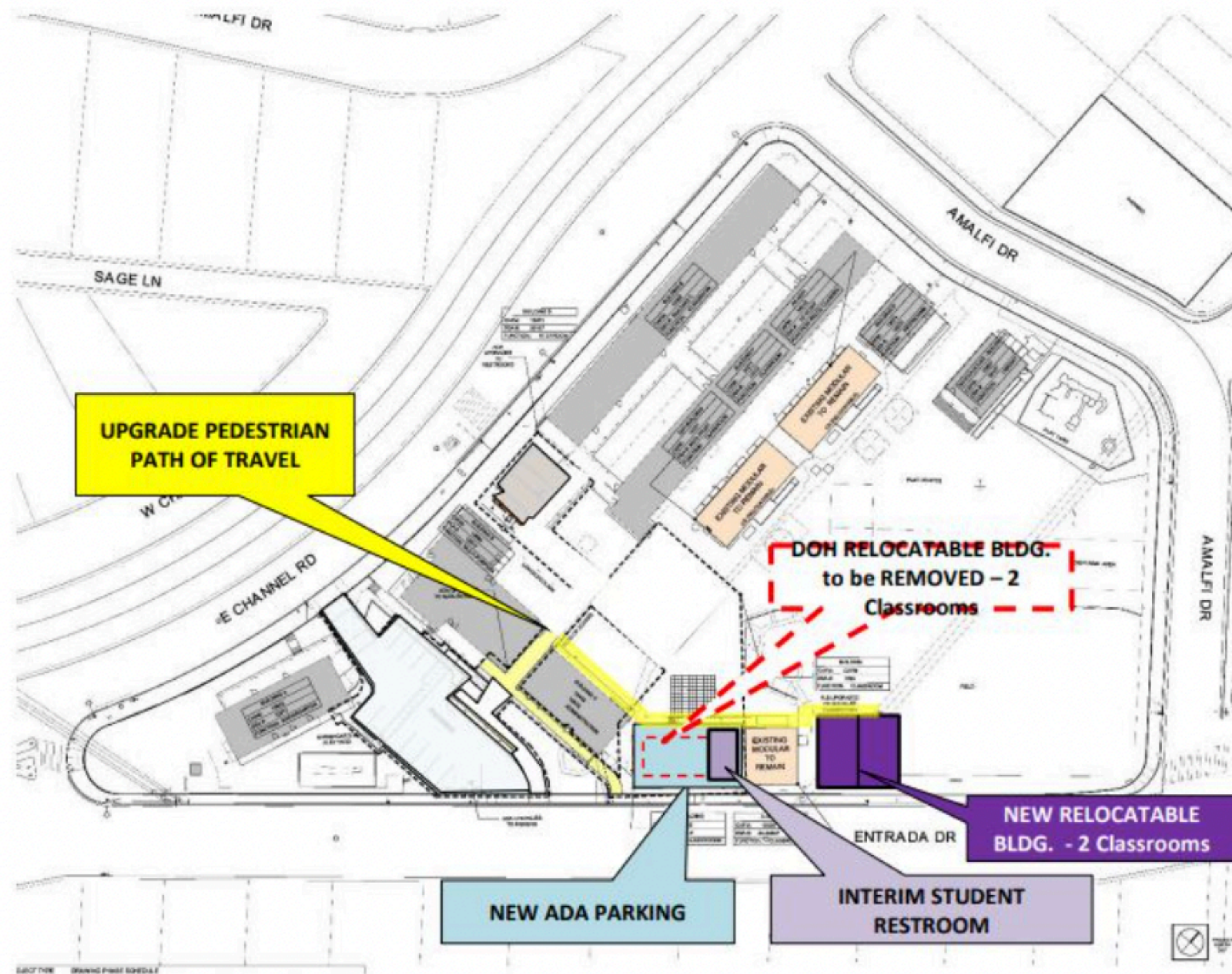



East Channel

Entrada Dr

©2019 Google













Entrada Dr

CANYON SCHOOL





FACILITIES SERVICES DIVISION

PROJECT UPDATE BULLETIN

CLASSROOM REPLACEMENT PROJECT

AT **CANYON CHARTER ELEMENTARY SCHOOL**

MAY 2023

we still anticipate starting construction by the end of this year, 2023.